

Orientation Instruction Sheet Details:

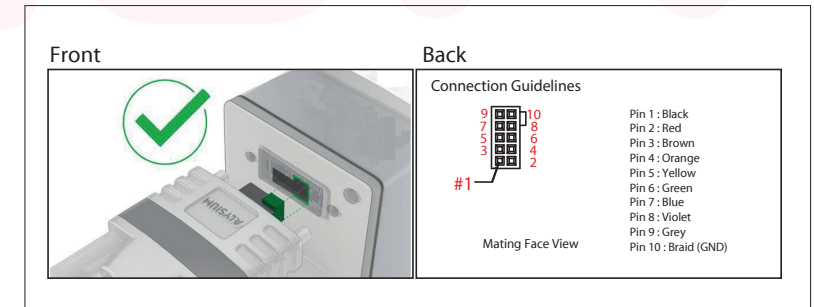

UNIT : mm  
UNLESS OTHERWISE SPECIFIED  
ASSY LENGTH TOLERANCE

|                       |        |
|-----------------------|--------|
| < 150mm               | = ±10  |
| ≥ 150mm and < 250mm   | = ±15  |
| ≥ 250mm and < 500mm   | = ±20  |
| ≥ 500mm and < 1000mm  | = ±30  |
| ≥ 1000mm and < 5000mm | = ±50  |
| 5000mm and above      | = ±100 |

This document is the property of Alysium-Tech. It must not be copied or otherwise disclosed without prior written consent

**RoHS COMPLIANT**

**BILL OF MATERIALS**

| Item | Description  |
|------|--|
| 1    | 10P(1.27) DRsI (DCT)<br>A81-9756 (1.27mm Pitch Dual Row Board To Board<br>10P Dual Row ) |
| 2    | A11-3069 [OD=4.5mm] <BLK>  |
| 3    | UL20276 9C#30(7/0.10)  |
| 4    | Processed End - Flat Cut   |
| 5    | Cable Label (White Pad Print)  |
| 6    | Orientation Instruction Sheet  |
| 6    | Heat Seal PE Bag   |

**WIRING DIAGRAM**

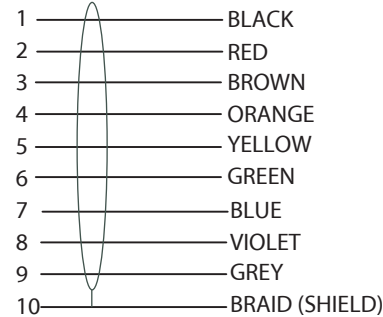

**PACKAGING DETAIL**

